



Hilton
Lisle/Naperville

Travel should take you places®

Hilton Lisle/Naperville

3003 Corporate West Drive, Lisle, Illinois 60532

Tel: 630-505-0900 or toll free at 800-552-2599

Guest Fax: 630-505-0479 Sales Fax: 630-505-8948

lislenaperville.hilton.com

Location

Located at I-88 and Naperville Road near the corporate offices of Kone, EMC², CA, Navistar, Alcatel, ConAgra, Unilever, BP, McCain, Aramark and MetLife. Just west of Chicago, 19 miles southwest of O'Hare International Airport, 22 miles northwest of Chicago Midway Airport, 3 miles from Chicago Metra Train Station and 27 miles from downtown Chicago.

For your next meeting or special event, call the Hilton Lisle/Naperville or visit lislenaperville.hilton.com.



Guestrooms & Suites Feature

- The Hilton Serenity Bed, featuring the Serta Perfect Sleeper Suite Dreams mattress, down pillows and luxurious linens
- Two double beds or one king bed with sleeper sofa
- Large work desk with convenient desk-level outlets and ergonomic chair
- High-speed wireless Internet access
- Two 2-line telephones with voicemail
- Deluxe bathrooms with granite vanities, Crabtree & Evelyn® bath amenities and curved shower curtain rods
- King room bathrooms feature walk-in shower
- 32" flat screen television with satellite TV and on-demand pay-per-view movies
- Innovative Hilton clock with easy-to-set alarm and adaptor for portable MP3
- Cuisinart® coffeemaker with complimentary Lavazza® coffee
- Complimentary USA Today® delivered each weekday morning
- Private keyed Club Level
- Accessible rooms available
- KOHLER BubbleMassage™ lighted jet tubs in suites
- Iron and ironing board; hair dryer
- Individual climate control
- Electronic door locks

Facilities & Services

- Express check-in kiosk with boarding pass printing
- Green Hotels Association member
- 18,000 sq. ft. of function space and 23 meeting rooms to accommodate up to 700 people
- Complete conference services staff and audio/visual team
- Creative themed events and catering
- Hilton Meetings participating hotel
- 309 guestrooms including 5 suites
- High-speed wireless Internet access in public space and meeting rooms
- Allgauer's award winning restaurant
- Allgauer's room service menu offers breakfast, lunch, dinner and late night dining
- The Bar at Allgauer's
- Heated indoor pool and whirlpool
- Hilton Fitness by Precor® facility
- Gift shop; ATM
- 24-hour business center
- Complimentary parking
- Valet laundry service available
- Complimentary shuttle service within 3 miles
- Multi-lingual staff

Hilton HHonors®

- Hilton HHonors is the only guest reward program that lets you earn both hotel points and airline miles for the same stay at more than 3,000 hotels worldwide.
- With the Hilton HHonors Event Planner program, Event Planners can earn Points & Miles® for qualifying events. Ask your salesperson for details.



Hilton HHonors



	L x W x H	Square Feet	Banquet	Theatre	Conference	Classroom	Reception	U-Shape	H-Square
LOBBY LEVEL									
Regency Ballroom	80' x 66' x 12'	5,280	480	700	—	400	600	—	—
Ash	32' x 22' x 12'	704	60	80	40	40	60	28	40
Elm	32' x 22' x 12'	704	60	80	40	40	60	28	40
Maple	32' x 22' x 12'	704	60	80	40	40	60	28	40
Pine	32' x 22' x 12'	704	60	80	40	40	60	28	40
Spruce	32' x 22' x 12'	704	60	80	40	40	60	28	40
Walnut	32' x 22' x 12'	704	60	80	40	40	60	28	40
Majestic Ballroom	62' x 72' x 11'	3,616	280	500	—	260	400	—	—
Birch	32' x 24' x 11'	768	50	70	34	40	60	28	34
Hickory	32' x 24' x 11'	768	60	80	40	40	60	28	40
Oak	32' x 24' x 11'	768	60	80	40	40	60	28	40
Willow	20' x 41' x 11'	820	80	90	42	60	80	36	42
Woods	56' x 34' x 11'	1,904	180	224	67	108	180	54	67
Redwood	28' x 34' x 11'	952	90	110	38	54	90	31	38
Rosewood	28' x 34' x 11'	952	90	110	38	54	90	31	38
Cypress	34' x 35' x 11'	1,190	100	156	48	78	100	35	48
Aspen	28' x 34' x 11'	952	90	110	38	54	90	31	38
Lisle Boardroom	17' x 28' x 10'	476	20	—	20	—	20	—	—
Naperville Boardroom	17' x 28' x 10'	476	20	—	20	—	20	—	—

LOWER CONFERENCE LEVEL

Parlor East & West	25' x 72' x 8'	1,800	180	190	—	145	180	—	—
Parlor East	25' x 38' x 8'	950	90	100	42	80	90	35	42
Parlor West	25' x 34' x 8'	850	60	90	40	65	60	34	40
Conference Room I	22' x 23' x 8'	506	50	50	24	25	45	18	24
Conference Room II	22' x 23' x 8'	506	50	50	24	25	45	18	24
Conference Room III	24' x 23' x 8'	552	50	50	24	25	45	18	24
Conference Room IV	24' x 23' x 8'	552	50	50	24	25	45	18	24

LOWER CONFERENCE LEVEL

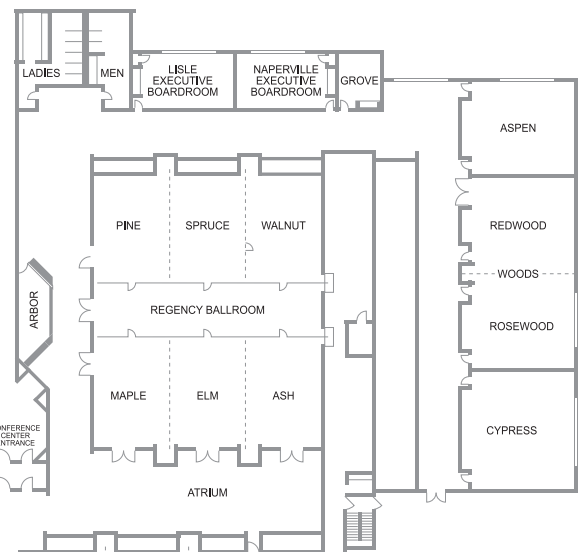
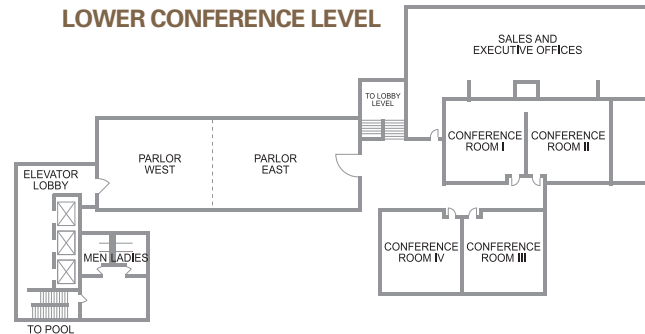

LOBBY LEVEL

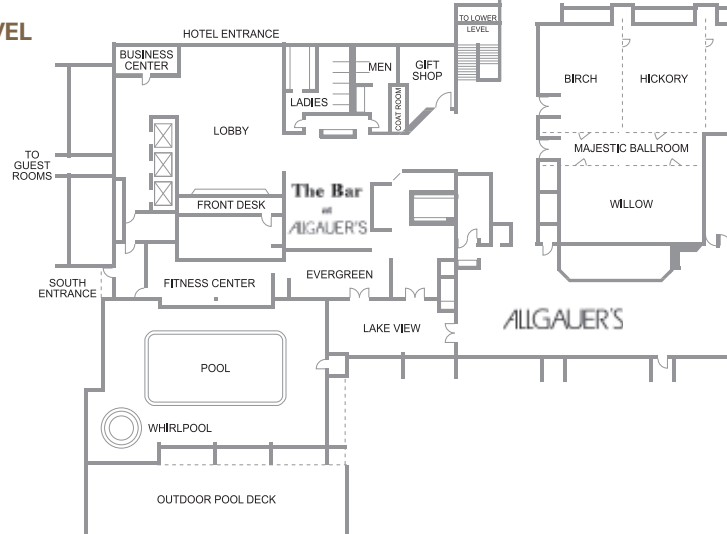

Call our dedicated Conference Professionals at 630-505-0900 or visit listenaperville.hilton.com

